

In case of emergency (for fire, police or ambulance) call **112**

“Do’s and “don’t’s

Exploring the countryside on foot or by bike is a wonderful way to get close to nature. However, the natural environment is fragile and you can help protect it by following the advice below.

Don't light fires. Take rubbish home. Keep dogs on a lead. Don't make unnecessary noise. Don't pick wild flowers. Check the weather forecast before you set out.

When in the forest, please obey warning signs, particularly about forestry work and hunting. The tracks that you are following are primarily for agricultural use. For your own safety, keep well away from agricultural machinery.

If you follow this advice you will be able to fully enjoy the countryside whilst protecting it for future generations.

Follow the signs 

Partners



Financial support from



European funds
for rural development:
Europe investing in rural areas



The double life of the Secret Country

Sandstone and the mysteries of the forest

This circular trail explores the Vosges part of Alsace Bossue. Mainly forested, the route passes through pleasant villages like Ratzwiller, Volksberg and Weislingen where you can stop for refreshment at local cafés or restaurants. This colourful trail will give you the chance to discover the natural diversity of the Eichel valley and to uncover the mysteries of the forested sandstone landscape. You will also find out about traditional construction techniques that take advantage of the properties of the local stone.



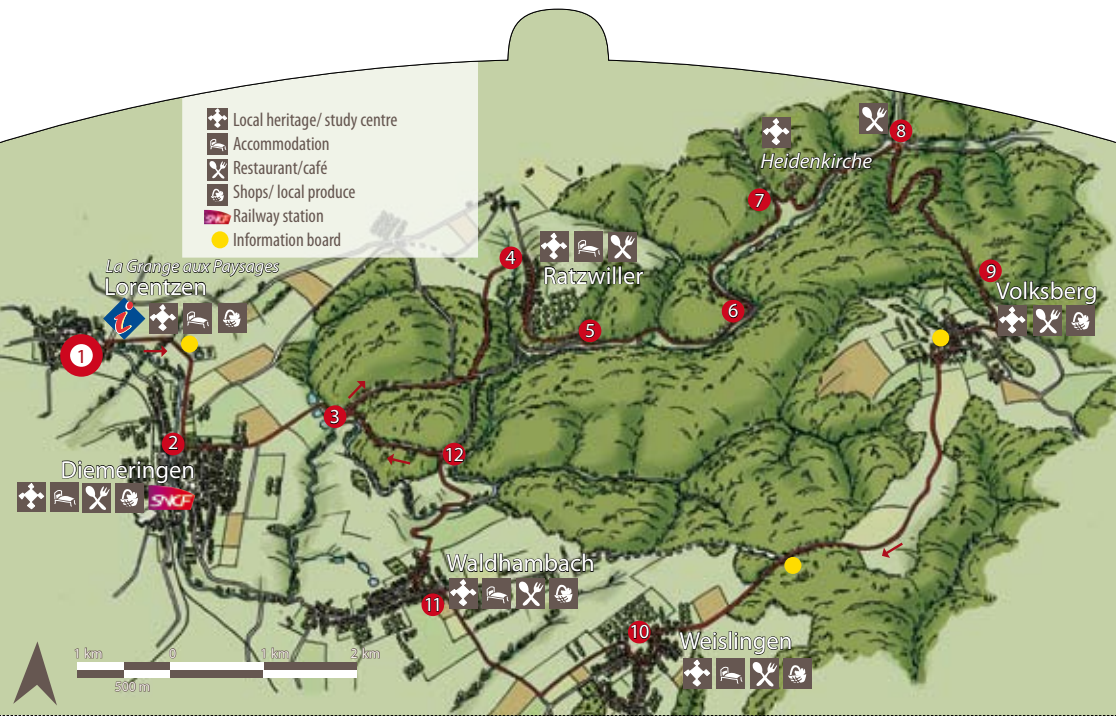

- 1 With your back to the Chateau of Lorentzen, turn left onto the D919. At the roundabout, turn left. Immediately after the River Eichel, take the first road on the right and follow it as far as Diemerdingen.
- 2 At the cemetery gates, turn left (rue de L'Etang). After the pond, continue for 200m to the edge of the forest.
- 3 Take the left fork and follow the road until you reach the roundabout in the forest. Turn left and follow the road as far as Ratzwiller.
- 4 At the give-way sign (cédez le passage), turn right and go through the village. At the outskirts of the village go straight on, following the path that goes into the forest.
- 5 At the junction, turn left and cycle down the Spielersbach valley. At Ratzwiller mill go straight on for 2km (1 mile) along the tarmac road.

- 6 When you come to a dirt track on the left (just before a wooden guardrail) leave the tarmac road. Take the track into the forest and go as far as the footbridge.
- 7 After the footbridge, bear right and continue as far as the site of the Heidenkirche. The Heidenkirche site is well worth a visit.
- 8 At the information board, turn right and then immediately left and continue as far as Speckbronn. When you reach the Auberge de la Source, take the forest track on your right and follow it for 3km (2 miles).
- 9 When the road forks, bear right. Go through Volksberg and follow the signs to Weislingen. Go into the village. When you reach the church, follow the 'Toutes directions' sign.
- 10 At the outskirts of the village, on the bend, take the rue des Cerises, on your right, just after the advertising signs. Continue as far as the crossroads and then bear right towards Waldhambach.
- 11 Just after the water tower, turn left then twice right. At the large walnut tree, go down to the right towards the forest and continue for 2km (1 mile) until you reach the Maison forestière (forestry building).
- 12 Turn onto the forest track on your left and rejoin this cycle trail at the forest roundabout (point 3 above) Retrace your route via Diemerdingen to the Chateau of Lorentzen.

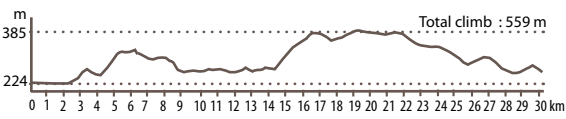

From the A4 Strasbourg/Metz motorway take exit 43 and drive towards Sare-Union. Then take the D8 and the D919 to Lorentzen. There is ample free parking near the start of this trail.

Start
In front of the Chateau of Lorentzen, next to the Grange aux Paysages exhibition and Tourist Office

Directions
From the A4 Strasbourg/Metz motorway take exit 43 and drive towards Sare-Union. Then take the D8 and the D919 to Lorentzen. There is ample free parking near the start of this trail.

3 H

559 m

31 km (19 miles)